

TOUCH DYNAMIC INC.

EC150 monitor wall mount installation

10/15/2012

Package contents

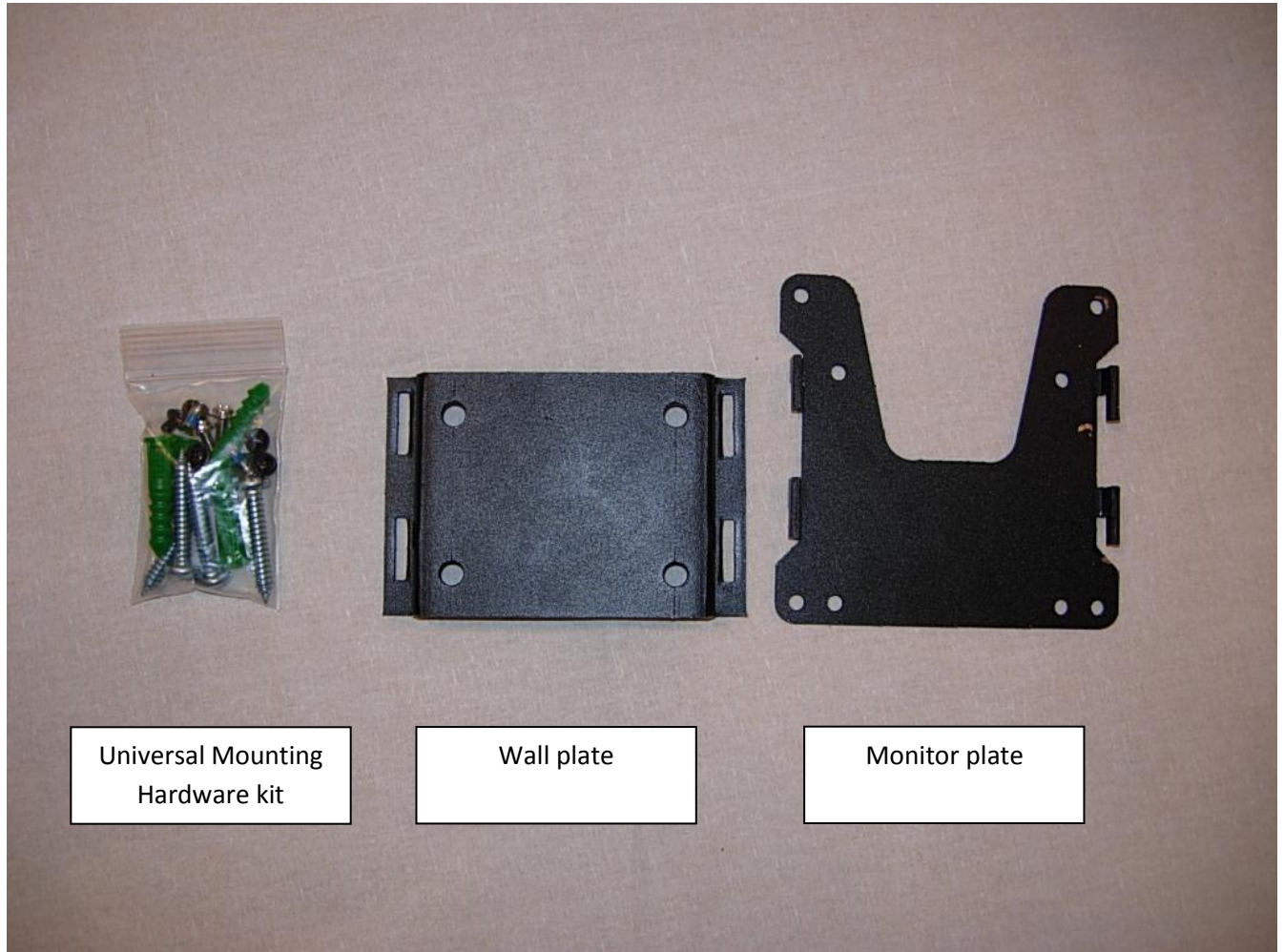

Installation Instructions

- 1) Disconnect all the cables from the monitor I/O ports and remove the power supply. Place the monitor on the flat secure surface
- 2) Remove 2 screws that secure the stand and remove the stand

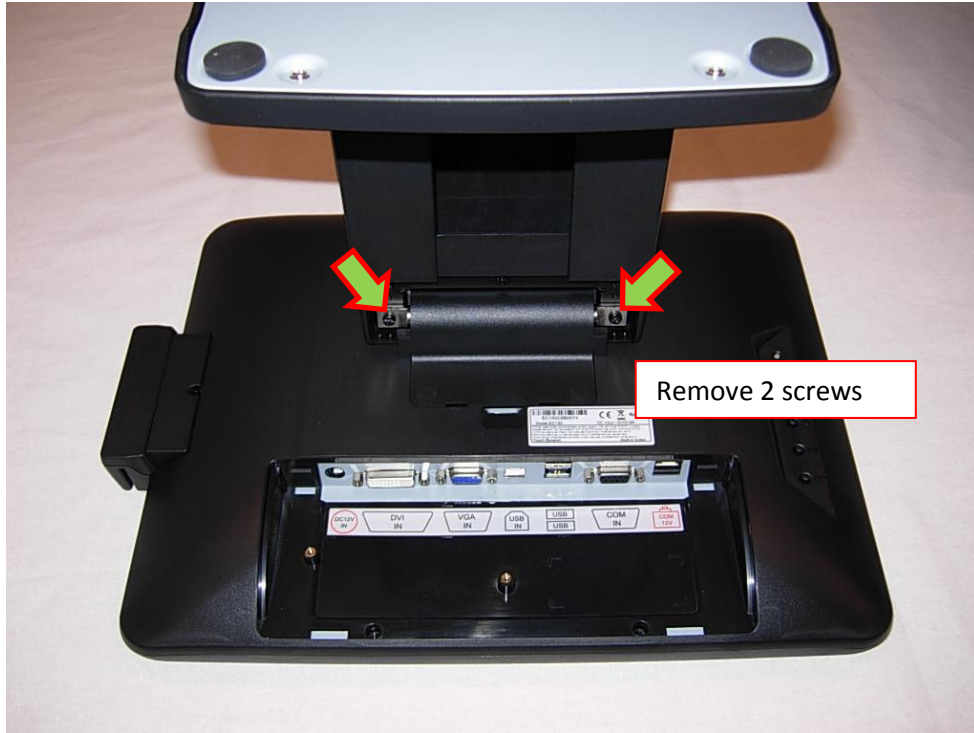

- 3) Remove 2 screws from the hinge cover

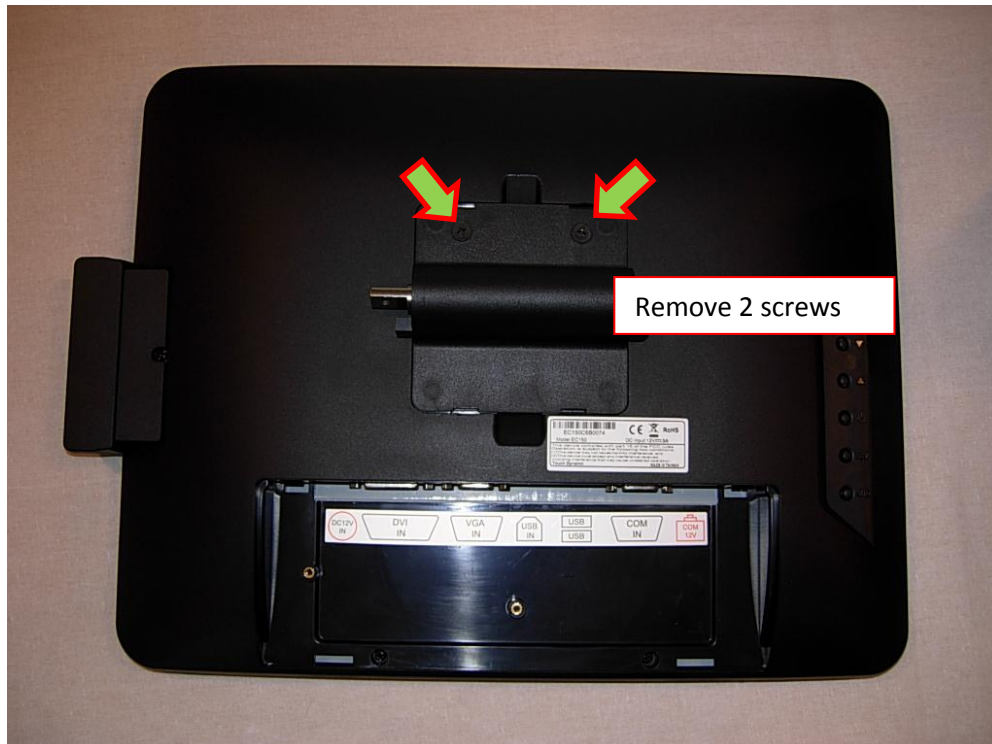

- 4) Use the flat screw driver to pull the cover up and remove it



- 5) Remove 4 screws from the hinge plate.



- 6) Put the monitor plate (the hooks should face down) and secure it with 4 screws

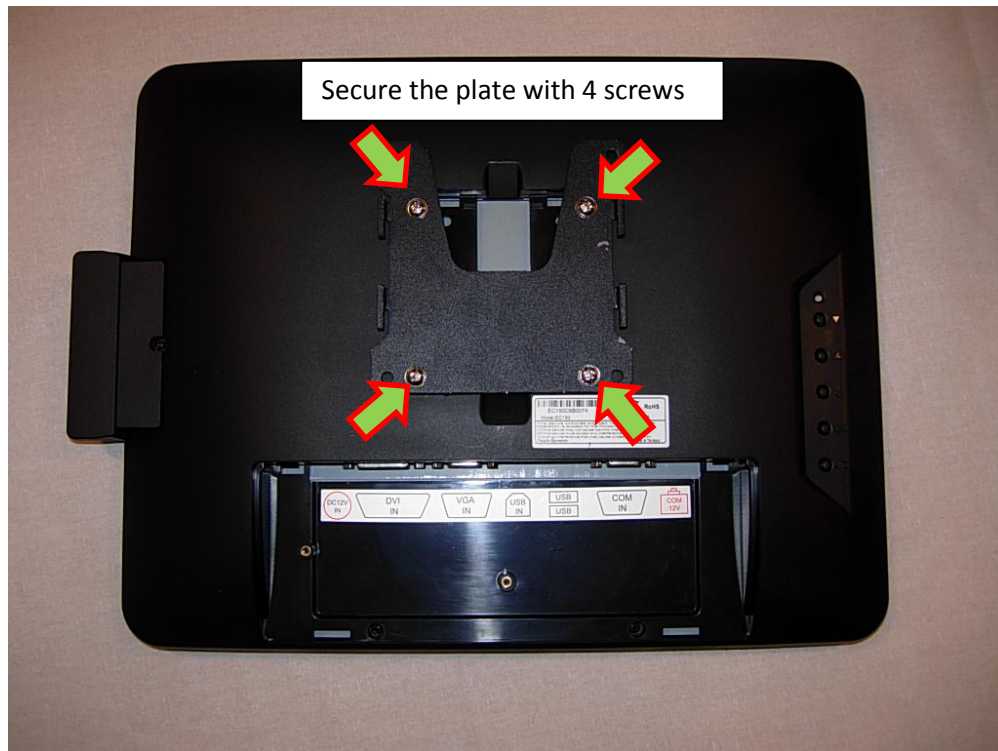

Install the wall mount bracket at the desired location on the wall and put the system on. All 4 hooks must be engaged to ensure the correct mounting.

Please note: The installation might require special tools (e.g. hammer drill, screw gun, level) and the understanding of the most common surface types (.e.g. sheetrock, concrete and wood) to determine the best mounting hardware needed to secure the wall plate (e.g. anchors for the concrete and sheetrock).